

ADA 5lbs opening force & closing speed control | **1,000,000 CYCLES TESTING**



MULTI-FUNCTION GATE CLOSER

Combined Performance:

- Hinge
- Gate Closer
- Hold Open
- Door Stop



PRACTICAL
ADJUSTABLE
DURABLE
ATTRACTIVE
VARIETY

Supports heavy gates, saves money, and works with multiple materials.
Satisfies ADA requirements with easily adjustable controlled closing speed.
Crafted with high quality stainless steel featuring leak-free patented design.
Sleek, compact design that's free of extraneous and obtrusive components.
Available in full-surface, side mount and butt gate closer types.



A Movement Revolution

Commercial Grade Stainless Steel
K51P - Full Surface Gate Closers
K51WP- Side Mount Gate Closers
K51MP - Butt Gate Closers

HOW TO ORDER

Product Identification

K51 MP -450 A3 -630 Other Functions

Materials

K51: Stainless Steel
(Type 304 is standard)

Closer Hinge Style

P: Full Surface, clamping
PS: Full Surface, screw-on
MP: Butt with cap
W: Side Mount without cap
WP: Side Mount with cap

Hinge Sizes

See drawings

Options

Upgrade to 316SST
Extenders for 3" & 4" post
Door Stop

Available in 90°, 110° or 120° depending on hinge type

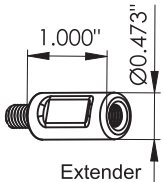
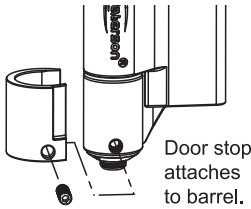

Finishes On Stainless Steel

630 (US32D) - Satin Stainless Steel
631 (US19) - Flat Black – Powder coating
695 - Dark Satin Bronze – Powder coating
731 (US4) - Satin Brass – Physical vapor deposition
Contact us for custom finishes.

Function Model

Purely Mechanical: A Mechanical + Hold Open: C
Hydraulic Hybrid: B Hydraulic + Hold Open: D

Hinges per Set

Sets are combinations of the following closer hinges, each with distinct functions.

DS	Double closing force	HA	Hydraulic damping + Swing speed adjustment
SA	Closing force + Swing speed adjustment	HS	Hydraulic damping + Closing force
SA1	Closing force + Latch speed adjustment	NM	No closing function (regular hinge)
SB	Closing force adjustment + Hold open		

CLOSER HINGE STYLE

K 51P
Full Surface Clamping Style

K51PS
Full Surface Screw-on Style

K51MP
Butt Hinge Style

K51W, no cap
K51WP, with cap
Side Mount Style

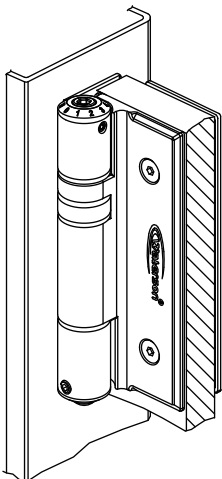
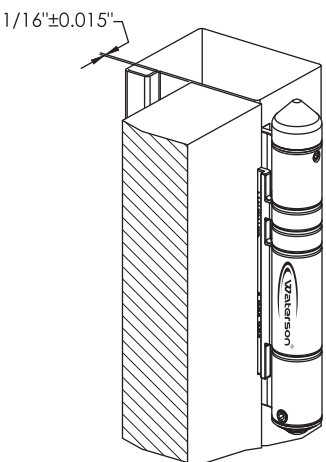
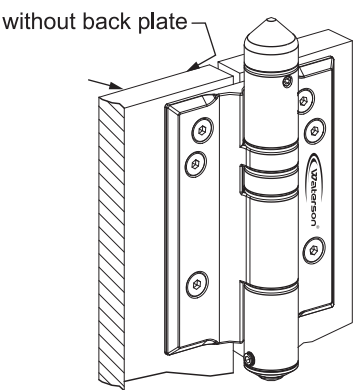
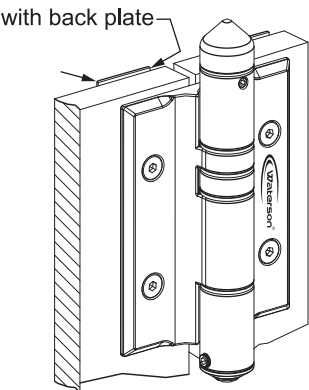

PRODUCT SELECTION TABLE

Stainless Steel Gate Closer Hinges

Gate (Maximums)			Operation		Closer Hinges		Sets of Closer Hinges (Style-Size-Set-Others)				
Post Thick. (inches)	W x H (feet)	Weight (pounds)	Hold Open	Mechanical: All locations. Hybrid: Softer closer, interior only.	Per Door	Configuration (See Models Table)	Hinge Type	Leaf Template height x width (inches)	Recommended Sets	Options	Finishes
1" -4"	4 x 6	150	NO	Mechanical	2	SA.SA1	Full Surface	5" x 4"	K51P-500-A2	Door Stop (90°,120°) Upgrade to 316	Stock  Stainless Steel US32D  Flat Black US19
				Hybrid	2	DS.HA	-	-	K51P-500-B2		
	4 x 7	260	NO	Mechanical	3	SA.SA.SA1	-	-	K51P-500-A3		
				Hybrid	3	DS.HA.SA	-	-	K51P-500-B3		
		260	YES	Mechanical	3	SB.SA.SA1	-	-	K51P-500-C3		
				Hybrid	3	DS.HA.SB	-	-	K51P-500-D3		
1.5"	4 x 6	150	NO	Mechanical	2	SA.SA1	Full Surface	5" x 4"	K51PS-500-A2	Door Stop (90°,120°) Upgrade to 316	Stainless Steel US32D  Flat Black US19
				Hybrid	2	DS.HA	-	-	K51PS-500-B2		
	4 x 7	260	NO	Mechanical	3	SA.SA.SA1	-	-	K51PS-500-A3		
				Hybrid	3	DS.HA.SA	-	-	K51PS-500-B3		
		260	YES	Mechanical	3	SB.SA.SA1	-	-	K51PS-500-C3		
				Hybrid	3	DS.HA.SB	-	-	K51PS-500-D3		
1.5" -2"	4 x 6	150	NO	Mechanical	2	SA.SA1	Butt Hinge With Weather Cap	4.5" x 4.5"	K51MP-450-A2	Door Stop (90°,120°) Upgrade to 316	Custom  Satin Brass US4  Dark Bronze 695
				Hybrid	2	DS.HA	-	-	K51MP-450-B2		
	4 x 7	260	NO	Mechanical	3	SA.SA.SA1	-	-	K51MP-450-A3		
				Hybrid	3	DS.HA.SA	-	-	K51MP-450-B3		
		260	YES	Mechanical	3	SB.SA.SA1	-	-	K51MP-450-C3		
				Hybrid	3	DS.HA.SB	-	-	K51MP-450-D3		
1" -4"	4 x 6	150	NO	Mechanical	2	SA.SA1	Side Mount Without Weather Cap	6" x 1.5"	K51W-600-A2	Door Stop (110°) Upgrade to 316	 Satin Brass US4  Dark Bronze 695
				Hybrid	2	HS.SA	-	-	K51W-600-B2		
	4 x 7	260	NO	Mechanical	3	SA.SA.SA1	-	-	K51W-600-A3		
				Hybrid	3	SA.HS.SA	-	-	K51W-600-B3		
		260	YES	Mechanical	3	SB.SA.SA1	-	-	K51W-600-C3		
				Hybrid	3	SA.HS.SB	-	-	K51W-600-D3		
1" -4"	4 x 6	150	NO	Mechanical	2	SA.SA1	Side Mount	6" x 1.5"	K51WP-600-A2	Door Stop (110°) Upgrade to 316	 Satin Brass US4  Dark Bronze 695
				Hybrid	2	HS.SA	-	-	K51WP-600-B2		
	4 x 7	260	NO	Mechanical	3	SA.SA.SA1	-	-	K51WP-600-A3		
				Hybrid	3	SA.HS.SA	-	-	K51WP-600-B3		
		260	YES	Mechanical	3	SB.SA.SA1	-	-	K51WP-600-C3		
				Hybrid	3	SA.HS.SB	-	-	K51WP-600-D3		

- See product data sheets, installation instructions, and limited warranty for additional information.
 ► Contact WATERSON (watersonusa.com) for other gate configurations and special conditions.



Heavy duty durable design



Easier to meet codes*



Maintains elegance



ADA 5lbs opening force



Simple & clean surface



Secure & effective latching



Quiet and controlled closing



Tall gate compatible

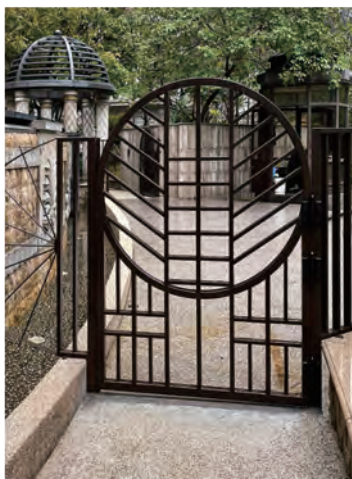

Fits multiple gate styles

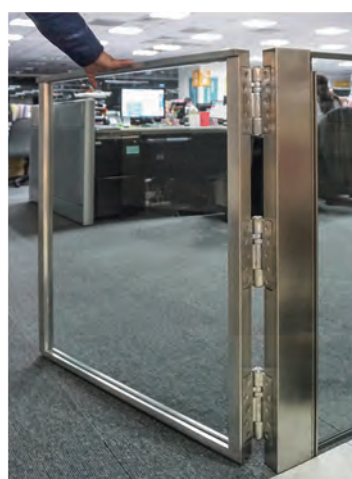

Reliable and long-lasting



Dependably weather resistant



Marine grade corrosion free

*Please follow ISPSC, IRC or local codes regarding hardware placement.



Waterson USA
861 Production Place,
Holland, MI, 49423

Phone: **+1-770-746-9758**
Website: **watersonusa.com**
Email: **hinges@watersonusa.com**